



Avoca Facade

Facade Image for illustration purposes only. Please refer to working drawings.

Jura16



Lot 219 Butternut Street WOLLERT

Lot Size: 296m²

Avoca facade

Fixed Price Package Inclusions

- + Driveway Included
- + 2590mm High Ceilings
- + Fixed price site costs
- + Guaranteed Site Start
- + Euro stainless steel cooktop & oven
- + Gas ducted heating
- + Estate covenants

Contact: Sumit Sarup 0433911495

pdxhomes.com.au

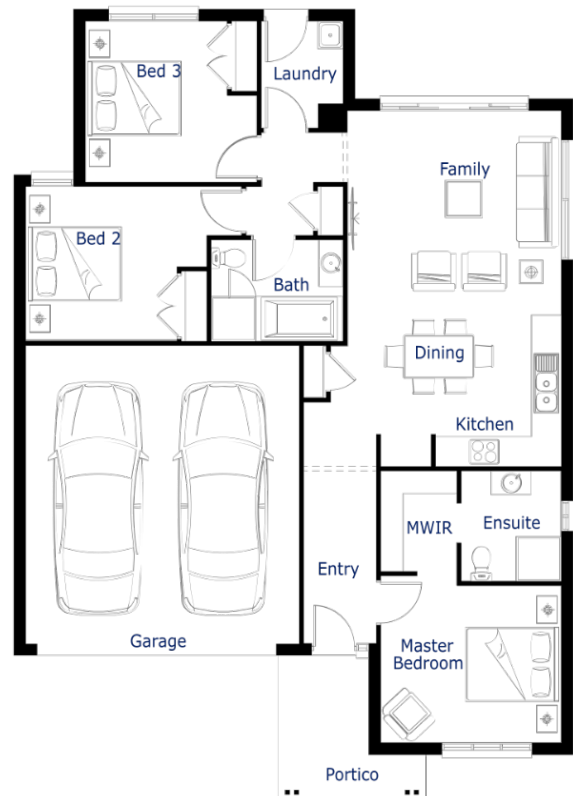

*Terms & Conditions: Package price is based on standard home, standard facade unless specified, builder's preferred siting and current promotion. Refer to sales consultant for actual working drawings for available facade options and inclusions. Pricing may vary due to actual land availability. Porter Davis reserves the right to change prices without notice. Fixed price packages are subject to developer's design review panel for final approval. \$2,000 non-refundable deposit only. First Home Buyer price less First Home Owner Grant subject to SRO eligibility criteria. If required via a town planning permit, client must provide landscaping and fencing etc at their own cost. Photos for illustration purposes only and include examples of upgrades not included in the package price. Refer to working drawings. Guaranteed site start subject to land title and finance availability. Geographic build zones apply. BAL rating up to 12.5 included, based on the standard home and specification. Should client variations after the requirements to achieve compliance, Porter Davis will debit or credit the client via a post contract variation. Package price correct at 11-10-2021.